

VMX-PFE™

The Choice for Light and Medium Duty Industrial Applications

200 - 480VAC, 1 - 28A, 1.5 - 20HP

IEC Rated Soft Starter



- Easy Setup just 3 settings
- Multi-Function LED Front Panel
- Start Duty: 3 x FLA within 23 sec.
- 24VDC Control Power
- Class 10 Overload Rating
- IP20 Enclosure
- Internal Bypass
- Only 1.8" wide (Size 1)
- DIN Rail Mounted

VMX-PFE™ Cost Effective Soft Starter

Key Features

Over Current Protection

Protects the Soft Starter against usage above its duty rating.

Internally Bypassed

Reduces cost once bypass is active. Reduces cabinet size and less heat produced.

Only 1.8" Wide (Size 1)

Same width as typical contactor and enables a more compact cabinet to be used.

Din-Rail Mount

For easy installation – it just clips on.

Typical Applications



Conveyors



Fans



Pumps



Compressors

Specifications

Operational Voltage	230 - 460 Vac (-15/+10%)
Rated Frequency	50 - 60 Hz +/- 2Hz
Index Rating	Class 10 – Ie: AC53b: 3-23: 697
Start per Hour	5 starts/stops per hour (max) - Class 10
Optimum Starts per Hour	30 starts/stops per hour (max) - Class 10 with optional fan
Internally Bypassed	Yes
Control Supply	24Vdc approx. 4VA supplied externally to terminals 0V - +24V
Enabled and Start/Soft Stop	24Vdc galvanically isolated terminals -A2, EN, +A1
Indication	Multifunction LEDs on front panel
Start Time	1 to 30 Seconds
Stop Time	0 to 30 Seconds
Start Duty	3 x FLC for 23 seconds at Trip Class 10 rating
Power Terminals	Input 1/L1, 3/ L2, 5/L3 Output 2/T1, 4/T2, 6/T3 IP20 rated wire clamping terminals
Enclosure	UL evaluated Open Type/IP20
Ambient Temperature	0° to 104°F without de-rating
Transport/storage	-13°F to 140°F -13°F to 167°F (not exceeding 24 hours)
Altitude	3280 ft (1000m), above 328ft (1000m) de-rate linearly by 1% of unit FLC per 328ft (100m), above 6562ft (2000m) contact factory.
Standards	IEC 60947-4-2; EN 60947-4-2 "AC Semiconductor Motor Controllers and Starters" UL, CE

Perfect for small AC Induction Motors

Setup as simple as 1,2, 3 in under a minute!

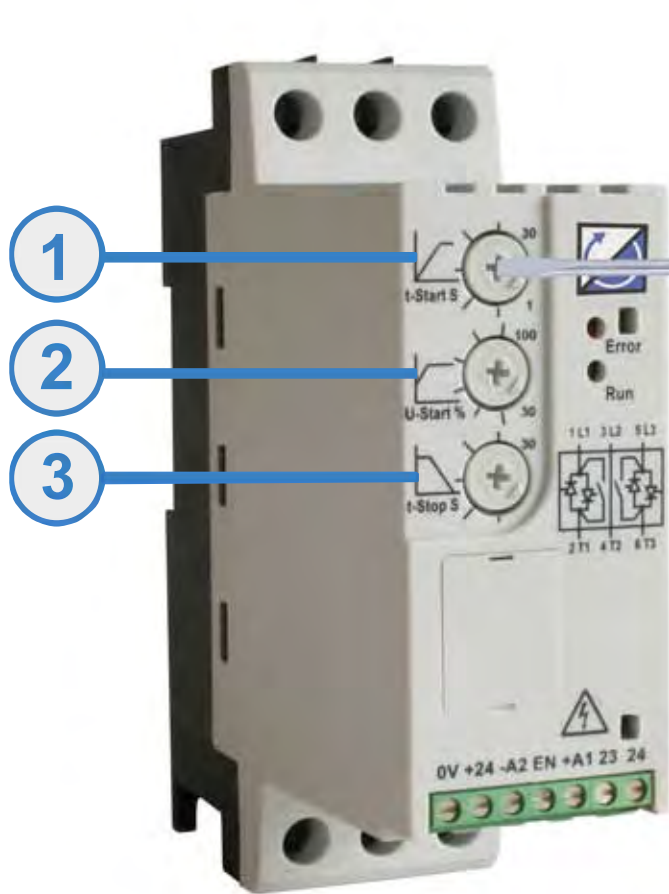

1. Acceleration / Start Time

Set acceleration time from 1-30 sec.

2. Start %

Set start voltage in percent of input voltage

3. Deceleration / Stop Time

Set deceleration time from 0 - 30 sec.

3S Technology

Automatic ramp control profiles ensure smooth start and stop performance, delivering stable acceleration and deceleration in all operating conditions.



Compact and Easy to Install

Ratings Sizing Guide

Model Number	Amps
VMX-PFE-02	3
VMX-PFE-04	3.4
VMX-PFE-06	4.8
VMX-PFE-08	4.8
VMX-PFE-10	7.6
VMX-PFE-12	11
VMX-PFE-14	14
VMX-PFE-16	14
VMX-PFE-18	21

230V		460V		Trip Class 10 PFE MODEL 5 starts/hour Ie: AC-53b: 3-23: 697
Amps	HP	Amps	HP	
2.2	0.5	3	1.5	VMX-PFE-02
3.2	0.75	3.4	2	VMX-PFE-04
4.2	1	4.8	3	VMX-PFE-06
6.8	2	4.8	3	VMX-PFE-08
9.6	3	7.6	5	VMX-PFE-10
9.6	3	11	7.5	VMX-PFE-12
15.2	5	14	10	VMX-PFE-14
22	7.5	21	15	VMX-PFE-18
28	10	27	20	VMX-PFE-18 + FAN

Dimensions and Weights

Model Number	Dim. H x W x D inches (mm)	Product Weight lbs. (kg)
VMX-PFE-02 thru VMX-PFE-10	5.51 (140) x 1.77 (45) x 4.73 (120)	0.88 (0.4)
VMX-PFE-12 thru VMX-PFE-18	6.5 (165) x 2.17 (55) x 4.73 (120)	1.43 (0.65)

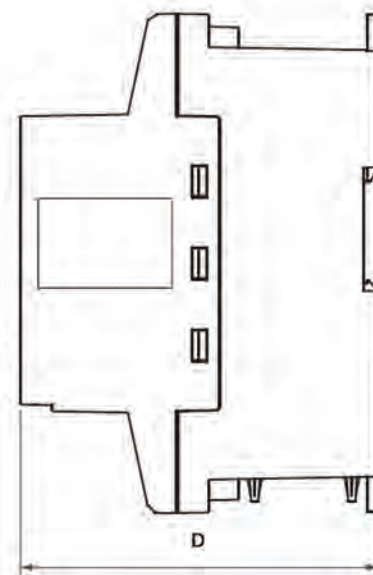
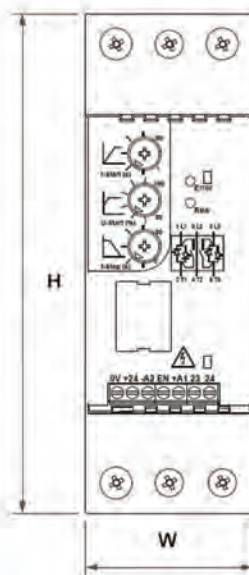

USA HEADQUARTERS

Motortronics / Phasetronics
 1600 Sunshine Drive
 Clearwater, Florida 33765
 USA
 Tel: +727-573-1819 / 888-767-7792
 Fax: +727-573-1803 / 800-548-4104
 E-mail: sales@motortronics.com
www.motortronics.com

UNITED KINGDOM

Motortronics UK
 Bristow House,
 Gillard Way, Ivybridge,
 Devon, PL21 9GG,
 United Kingdom
 Tel: +44 (0)1752-894554
www.motortronics-uk.co.uk

SOUTH KOREA

Motortronics Int'l Korea Co Ltd
 #1607, 128 Gasan digital 1-ro,
 Gasan digital 1-ro,
 Geumcheon-gu,
 Seoul 08507, Republic of Korea
 Tel: 82-2-867-5808
 Fax: 82-2-867-6004
www.motortronics-korea.com

CHINA

M & P Machinery & Electronics Control
 Part of the Motortronics Group
 32 Jiaxin Road,
 Jimo,
 Qingdao, China 266229
 Tel: 86-532-81725028
 Fax: 86-532-81725038
www.mp-cn.com

UNITED ARAB EMIRATES

Motortronics MEA, LLC
 Sharjah Media City,
 Sharjah,
 United Arab Emirates
 Tel: +1 971-50 763 4920
www.motortronics.com

PN: VMX-PFE-080620