

# KBU 23

## Split-core current transformer

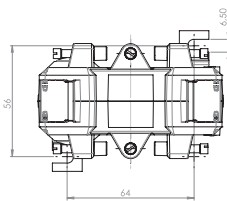

Bus bar 1            20 x 30 mm  
 Round conductor    20 mm  
 Transformer width   93 mm  
 Height                106 mm  
 Depth                 58 mm

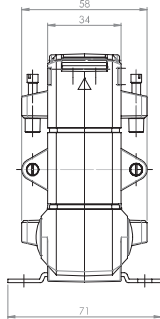
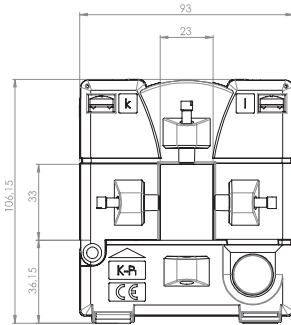

Primary current [A]	Burden [VA]	Secondary current [A] / Class		
		1 A Cl. 3 Art.-no.	1 A Cl. 1 Art.-no.	1 A Cl. 0,5 Art.-no.
100	1,25	80248		
150	1,5	80230		
200	2,5	80231		
250	1,5		80244	
300	3,75		80245	
400	1			80237
	5		80246	

Primary current [A]	Burden [VA]	Secondary current [A] / Class		
		5 A Cl. 3 Art.-no.	5 A Cl. 1 Art.-no.	5 A Cl. 0,5 Art.-no.
100	1,25	80048		
150	1,5	80030		
200	2,5	80031		
250	1,5		80044	
300	3,75		80045	
400	1			80037
	5		80046	