



Continuous light element, with integrated LED, blue, 230 V AC, Diameter 70 mm

| | | |
|--|--------------------------|---------------------------|
| product brand name | SIRIUS | |
| product designation | Continuous light element | |
| design of the product | including light sources | |
| General technical data | | |
| type of voltage of the operating voltage | AC | |
| operating voltage | | |
| • 1 at AC at 50 Hz rated value | 230 V | |
| • 1 at AC at 60 Hz rated value | 230 V | |
| relative positive tolerance of the operating voltage | 10 % | |
| relative negative tolerance of the operating voltage | -10 % | |
| consumed current maximum | 35 mA | |
| reference code according to EN 61346-2 | P | |
| Lamp | | |
| product component light source | Yes | |
| type of light source | LED | |
| service life of LED | 100 000 h | |
| design of the optical signal | continuous light | |
| light intensity | 0.09 cd | |
| light intensity | 0.06 ... 0.13 cd | |
| Enclosure | | |
| height | 65.5 mm | |
| width | 70 mm | |
| outer diameter of the signal column element | 70 mm | |
| material | PC | |
| color | blue | |
| fastening method | Bayonet | |
| protection class IP | IP65 | |
| Ambient conditions | | |
| ambient temperature during operation | -20 ... +50 °C | |
| Certificates/ approvals | | |
| General Product Approval | EMC | Declaration of Conformity |

[Confirmation](#)



other

Further information

Siemens has decided to exit the Russian market (see here).

<https://press.siemens.com/global/en/pressrelease/siemens-wind-down-russian-business>

Siemens is working on the renewal of the current EAC certificates.

Please contact your local Siemens office on the status of validity of the EAC certification if you intend to import or offer to supply these products to an EAC relevant market (other than the sanctioned EAEU member states Russia or Belarus).

Information on the packaging

<https://support.industry.siemens.com/cs/ww/en/view/109813875>

Information- and Downloadcenter (Catalogs, Brochures,...)

<https://www.siemens.com/ic10>

Industry Mall (Online ordering system)

<https://mall.industry.siemens.com/mall/en/en/Catalog/product?mlfb=8WD4450-5AF>

Cax online generator

<http://support.automation.siemens.com/WWW/CAXorder/default.aspx?lang=en&mlfb=8WD4450-5AF>

Service&Support (Manuals, Certificates, Characteristics, FAQs,...)

<https://support.industry.siemens.com/cs/ww/en/ps/8WD4450-5AF>

Image database (product images, 2D dimension drawings, 3D models, device circuit diagrams, EPLAN macros, ...)

http://www.automation.siemens.com/bilddb/cax_de.aspx?mlfb=8WD4450-5AF&lang=en

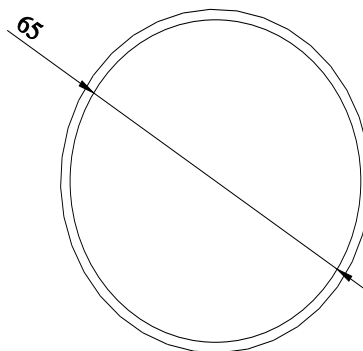
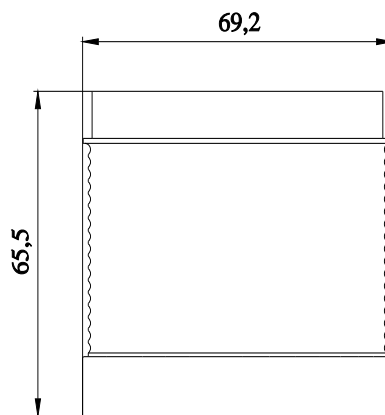

-P



last modified:

8/29/2023 