



Single-flash light element, w. built-in electronic flash, clear, 230 V AC, Diameter 70 mm

product brand name	SIRIUS	
product designation	Flashlight element	
design of the product	including light sources	
<b>General technical data</b>		
type of voltage of the operating voltage	AC	
operating voltage	<ul style="list-style-type: none"> <li>• 1 at AC at 50 Hz rated value 230 V</li> <li>• 1 at AC at 60 Hz rated value 230 V</li> </ul>	
relative positive tolerance of the operating voltage	10 %	
relative negative tolerance of the operating voltage	-10 %	
reference code according to EN 61346-2	P	
<b>Lamp</b>		
product component light source	Yes	
type of light source	Xenon gas discharge lamp	
design of the optical signal	flash light	
light intensity	43 797 cd	
flash frequency	1 Hz	
number of flashes of light element	4 000 000	
<b>Enclosure</b>		
height	65.5 mm	
width	70 mm	
outer diameter of the signal column element	70 mm	
material	PC	
color	clear	
fastening method	Bayonet	
protection class IP	IP65	
<b>Ambient conditions</b>		
ambient temperature during operation	-20 ... +50 °C	
<b>Certificates/ approvals</b>		
General Product Approval	EMC	Declaration of Conformity

[Confirmation](#)



other

[Confirmation](#)

## Further information

Siemens has decided to exit the Russian market (see here).

<https://press.siemens.com/global/en/pressrelease/siemens-wind-down-russian-business>

Siemens is working on the renewal of the current EAC certificates.

Please contact your local Siemens office on the status of validity of the EAC certification if you intend to import or offer to supply these products to an EAC relevant market (other than the sanctioned EAEU member states Russia or Belarus).

Information on the packaging

<https://support.industry.siemens.com/cs/ww/en/view/109813875>

Information- and Downloadcenter (Catalogs, Brochures,...)

<https://www.siemens.com/ic10>

Industry Mall (Online ordering system)

<https://mall.industry.siemens.com/mall/en/en/Catalog/product?mlfb=8WD4450-0CE>

Cax online generator

<http://support.automation.siemens.com/WW/CAXorder/default.aspx?lang=en&mlfb=8WD4450-0CE>

Service&Support (Manuals, Certificates, Characteristics, FAQs,...)

<https://support.industry.siemens.com/cs/ww/en/ps/8WD4450-0CE>

Image database (product images, 2D dimension drawings, 3D models, device circuit diagrams, EPLAN macros, ...)

[http://www.automation.siemens.com/bilddb/cax\\_de.aspx?mlfb=8WD4450-0CE&lang=en](http://www.automation.siemens.com/bilddb/cax_de.aspx?mlfb=8WD4450-0CE&lang=en)

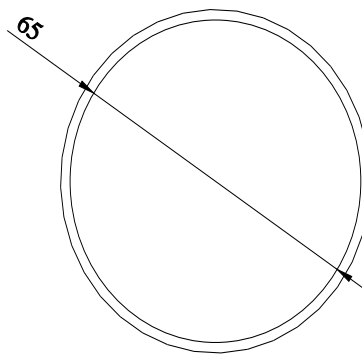
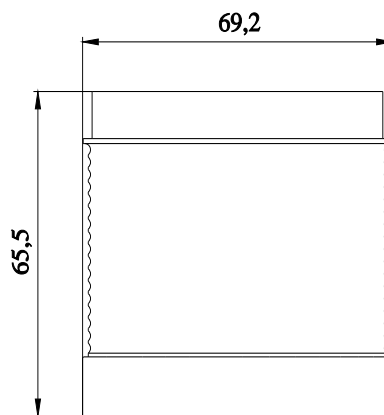

**-P**

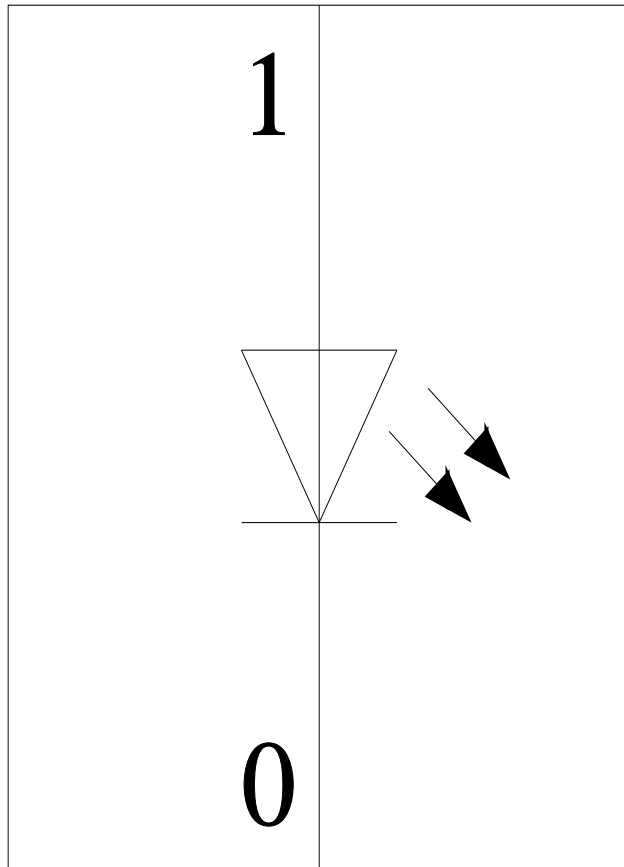

last modified:

8/29/2023 