

Continuous light element, with integrated LED, yellow, 115 V AC, Diameter 70 mm

product brand name	SIRIUS
product designation	Continuous light element
design of the product	including light sources

General technical data

type of voltage of the operating voltage	AC
operating voltage	
• 1 at AC at 50 Hz rated value	115 V
• 1 at AC at 60 Hz rated value	115 V
relative positive tolerance of the operating voltage	10 %
relative negative tolerance of the operating voltage	-10 %
consumed current maximum	25 mA
reference code according to EN 61346-2	P

Lamp

product component light source	Yes
type of light source	LED
service life of LED	100 000 h
design of the optical signal	continuous light
light intensity	0.74 cd
light intensity	0.5 ... 1.05 cd

Enclosure

height	65.5 mm
width	70 mm
outer diameter of the signal column element	70 mm
material	PC
color	yellow
fastening method	Bayonet
protection class IP	IP65

Ambient conditions

ambient temperature during operation	-20 ... +50 °C
--------------------------------------	----------------

Certificates/ approvals

General Product Approval	EMC	Declaration of Conformity
--------------------------	-----	---------------------------

[Confirmation](#)



other

[Confirmation](#)

Further information

Siemens has decided to exit the Russian market (see here).

<https://press.siemens.com/global/en/pressrelease/siemens-wind-down-russian-business>

Siemens is working on the renewal of the current EAC certificates.

Please contact your local Siemens office on the status of validity of the EAC certification if you intend to import or offer to supply these products to an EAC relevant market (other than the sanctioned EAEU member states Russia or Belarus).

Information on the packaging

<https://support.industry.siemens.com/cs/ww/en/view/109813875>

Information- and Downloadcenter (Catalogs, Brochures,...)

<https://www.siemens.com/ic10>

Industry Mall (Online ordering system)

<https://mall.industry.siemens.com/mall/en/en/Catalog/product?mlfb=8WD4440-5AD>

Cax online generator

<http://support.automation.siemens.com/WW/CAXorder/default.aspx?lang=en&mlfb=8WD4440-5AD>

Service&Support (Manuals, Certificates, Characteristics, FAQs,...)

<https://support.industry.siemens.com/cs/ww/en/ps/8WD4440-5AD>

Image database (product images, 2D dimension drawings, 3D models, device circuit diagrams, EPLAN macros, ...)

http://www.automation.siemens.com/bilddb/cax_de.aspx?mlfb=8WD4440-5AD&lang=en

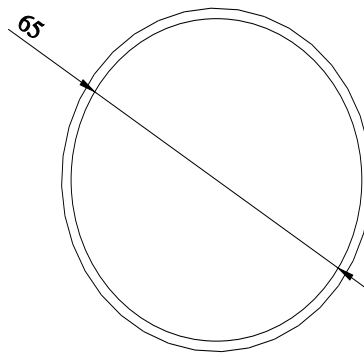
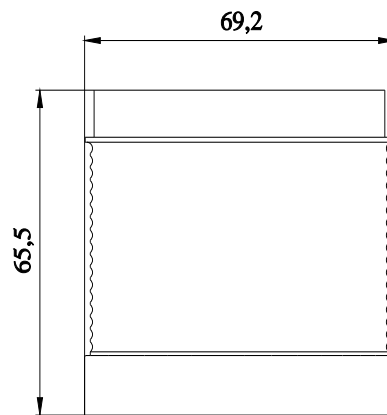

-P

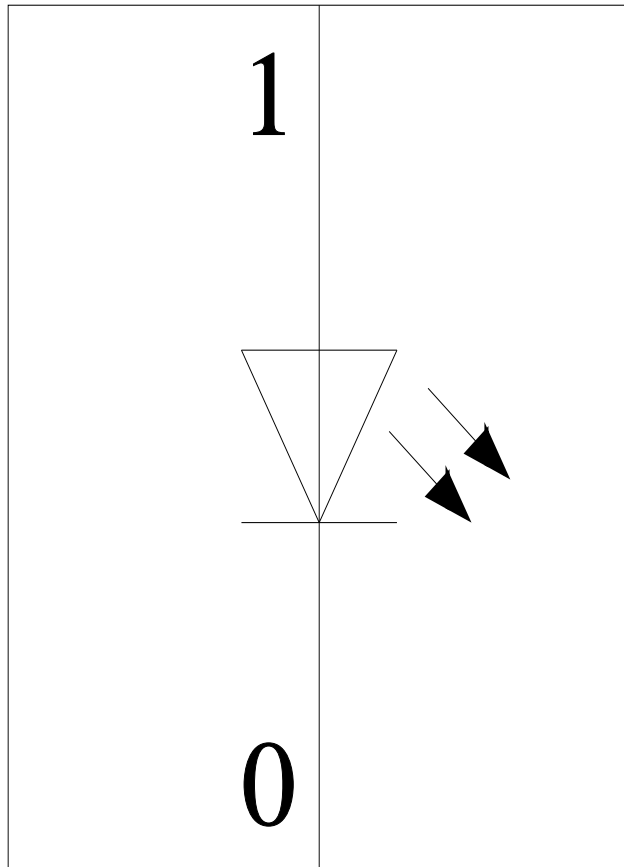

last modified:

8/29/2023 