



Insert cap for pushbutton and illuminated pushbutton raised, clear with black font, with inscription: Up

Figure similar

| General technical data                      |    |                    |
|---|----|--------------------|
| shape of the name plate for command devices |    | round              |
| color of the label                          |    | clear              |
| outer diameter                              | mm | 11                 |
| printed marking                             |    | AUF                |
| printed ISO symbols                         |    | without ISO symbol |

| Certificates/ approvals  |                           |                   |
|--------------------------|---------------------------|-------------------|
| General Product Approval | Declaration of Conformity | Test Certificates |



[Miscellaneous](#)

other

[Confirmation](#)

### Further information

Siemens has decided to exit the Russian market (see here).  
<https://press.siemens.com/global/en/pressrelease/siemens-wind-down-russian-business>  
 Siemens is working on the renewal of the current EAC certificates.  
 Please contact your local Siemens office on the status of validity of the EAC certification if you intend to import or offer to supply these products to an EAC relevant market (other than the sanctioned EAEU member states Russia or Belarus).  
**Information on the packaging**  
<https://support.industry.siemens.com/cs/ww/en/view/109813875>  
**Information- and Downloadcenter (Catalogs, Brochures,...)**  
<https://www.siemens.com/ic10>  
**Industry Mall (Online ordering system)**  
<https://mall.industry.siemens.com/mall/en/en/Catalog/product?mlfb=3SB2901-5AD>  
**Cax online generator**  
<http://support.automation.siemens.com/WW/CAXorder/default.aspx?lang=en&mlfb=3SB2901-5AD>  
**Service&Support (Manuals, Certificates, Characteristics, FAQs,...)**  
<https://support.industry.siemens.com/cs/ww/en/ps/3SB2901-5AD>  
**Image database (product images, 2D dimension drawings, 3D models, device circuit diagrams, EPLAN macros, ...)**  
[http://www.automation.siemens.com/bilddb/cax\\_de.aspx?mlfb=3SB2901-5AD&lang=en](http://www.automation.siemens.com/bilddb/cax_de.aspx?mlfb=3SB2901-5AD&lang=en)

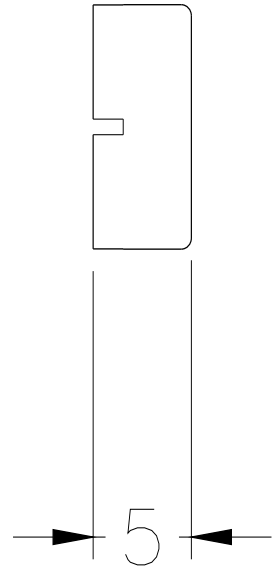
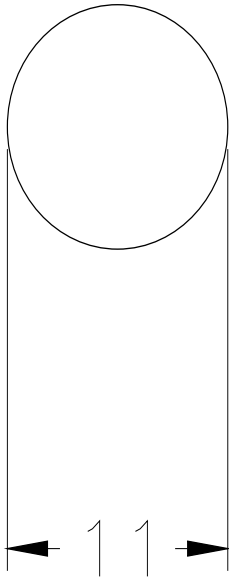

---

last modified:

3/16/2023 