



ASIsafe Basis Safety monitor 2 F-RO 2 enabling circuits IP20, with screw terminal removable terminals Safe output relay Response time maximum 40 ms Monitor type 2, Version 3 Can be used up to Category 4 (EN954-1) up to PL E (EN ISO 13849-1) up to SIL 3 (IEC 61508)

General technical data		
design of the product		safety monitor
protocol is supported AS-Interface protocol		Yes
Type		2 enabling circuits
number of release circuits		2
Response time max.	ms	40
type of electrical connection of the inputs and outputs		screw terminal
Rated operational current I _e		
• AC-12, 50/60 Hz 250 V	A	3
• AC-15, 50/60 Hz		
— 115 V	A	3
— 230 V	A	3
• DC-12 (DC-1) 24 V	A	3
• DC-13 (DC-11)		
— 24 V	A	1
— 115 V	A	0.1
— 230 V	A	0.05
reference code according to DIN 40719 extended according to IEC 204-2 according to IEC 750		A
reference code according to EN 61346-2		F
Ambient conditions		
ambient temperature		
• during operation	°C	-20 ... +60
• during storage	°C	-30 ... +70
protection class IP		IP20
Mechanical data		
width	mm	45
height	mm	108
depth	mm	120
fastening method		screws / DIN rail
Certificates/ approvals		
General Product Approval	EMC	Functional Safety/Safety of Machinery



[Confirmation](#)



[Type Examination Certificate](#)



other

[Confirmation](#)

Further information

Siemens has decided to exit the Russian market (see here).

<https://press.siemens.com/global/en/pressrelease/siemens-wind-down-russian-business>

Siemens is working on the renewal of the current EAC certificates.

Please contact your local Siemens office on the status of validity of the EAC certification if you intend to import or offer to supply these products to an EAC relevant market (other than the sanctioned EAEU member states Russia or Belarus).

Information on the packaging

<https://support.industry.siemens.com/cs/ww/en/view/109813875>

Information- and Downloadcenter (Catalogs, Brochures,...)

<https://www.siemens.com/ic10>

Industry Mall (Online ordering system)

<https://mall.industry.siemens.com/mall/en/en/Catalog/product?mlfb=3RK1105-1BE04-0CA0>

Cax online generator

<http://support.automation.siemens.com/WW/CAXorder/default.aspx?lang=en&mlfb=3RK1105-1BE04-0CA0>

Service&Support (Manuals, Certificates, Characteristics, FAQs,...)

<https://support.industry.siemens.com/cs/ww/en/ps/3RK1105-1BE04-0CA0>

Image database (product images, 2D dimension drawings, 3D models, device circuit diagrams, EPLAN macros, ...)

http://www.automation.siemens.com/bilddb/cax_de.aspx?mlfb=3RK1105-1BE04-0CA0&lang=en

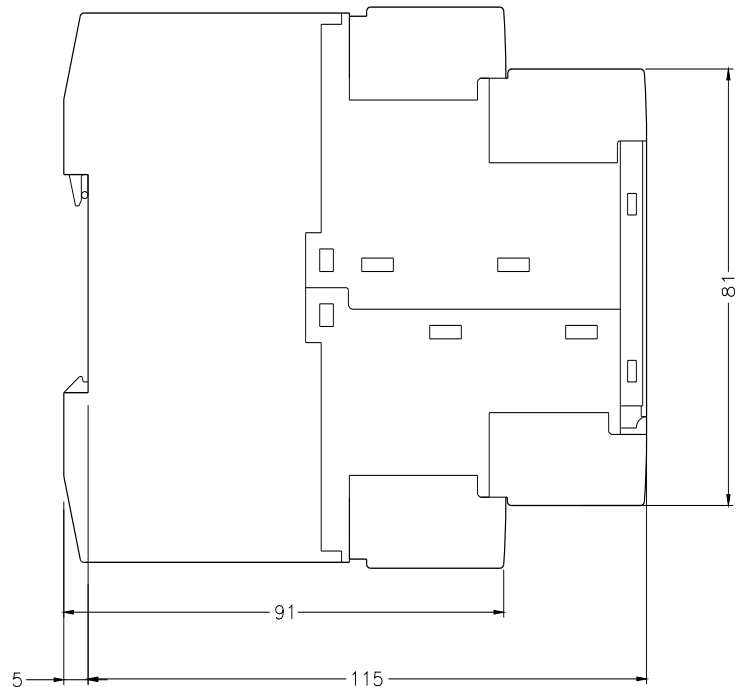
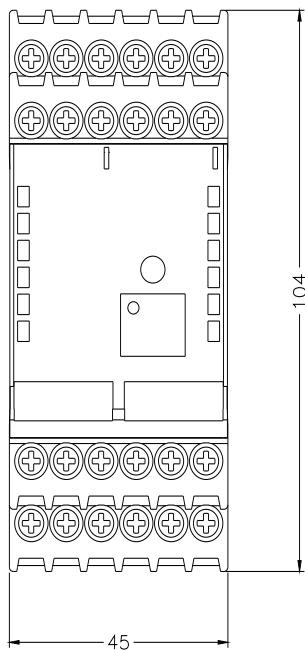

last modified:

9/5/2023