



ACCESSORI / ACCESSORIES
ACCESSOIRES (TWS - miniTWS - babyTWS)

BS



BS
27760 27691

PR



PR
0,03

KIT



KIT
0,06

KIT SS



KIT SS
0,28

KIT SS L10



KIT SS L10
0,14

KIT SS L20



KIT SS L20
0,18

KIT SS L40



KIT SS L40
0,28

PR	27761	27692
KIT	27764	27695
KIT SS L10	27765	27845
KIT SS L20	27766	27846
KIT SS L40	27767	27847

BP1



BP1
0,04

BP2



BP2
0,05

BP1	27762	27693
BP2	27763	27694

SB



SB
0,14

SB



SB
33357 33358

M16



M16
0,10

M16



M16
27777 27778

BS

- Base piana per montaggio superficiale
- Flat base for surface mount
- Base pour montage à plat

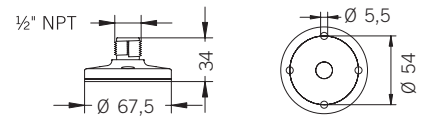

PR

- 10 cm extension
- 10 cm extension
- 10 cm de prolongation

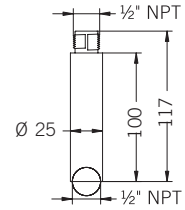

KIT

- Base piana per montaggio superficiale con estensione di 10 cm
- Flat base for surface mount with 10 cm extension
- Base pour montage à plat avec 10 cm de prolongation

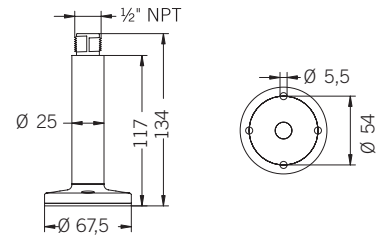

KIT SS L10 - L20 - L40

- Base piana per montaggio superficiale con estensione in acciaio INOX di 10 cm (disponibile anche con misura 20 e 40 cm)
- Flat base for surface mount with 10 cm stainless steel extension (also available in 20 and 40 cm sizes)
- Base pour montage à plat avec extension en acier inoxydable de 10 cm (aussi disponible en taille de 20 et 40 cm)

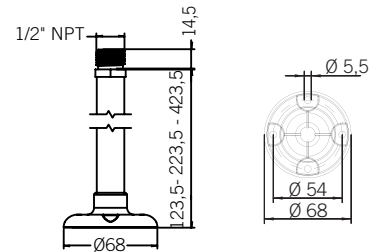

BP1

- Base parete per montaggio laterale
- Wall base for side mount
- Support fixation en applique (à filetage simple)

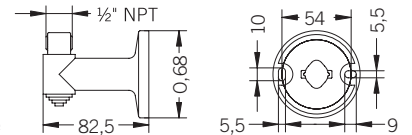

BP2

- Base parete per montaggio laterale di 2 colonne
- Wall base for side mount of 2 towers
- Support fixation en applique (à double filetage) pour 2 colonnes lumineuses

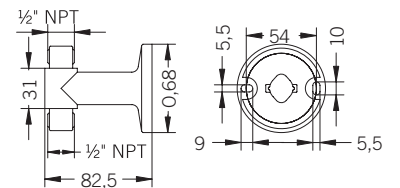

SB

- Staffa in acciaio INOX per montaggio laterale con pressacavo 1/2" NPT
- Stainless steel bracket with 1/2" NPT cable gland
- Support en acier inoxydable avec un presse-étoupe 1/2" NPT

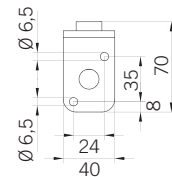

M16

- Base piana per montaggio superficiale con pressacavo M16
- Flat base with M16 cable gland for surface mount
- Base pour montage à plat avec presse-étoupe M16

