

**CLI C 3-6 BL/WS - MP****Weidmüller Interface GmbH & Co. KG**

Klingenbergstraße 26

D-32758 Detmold

Germany

www.weidmueller.com

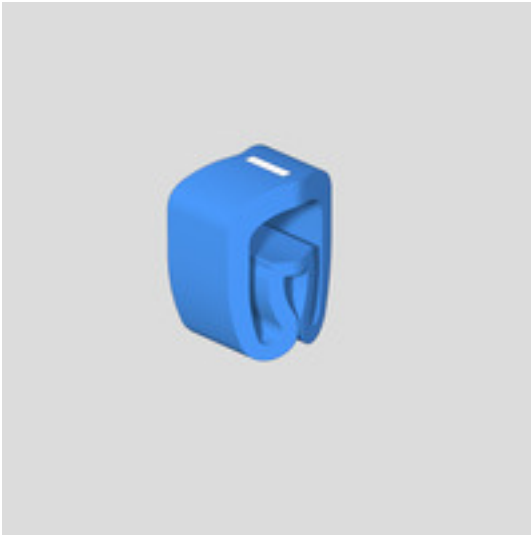

CLI C conductor markers are mounted on unconnected conductors. Four different sizes are available for labelling conductor cross-sections from 0.5 mm<sup>2</sup> to max. 70 mm<sup>2</sup>. The markers are already printed and ready for use. Individual labelling is possible by combining the individual markers.

- Closed markers, reliable and for mounting on unconnected cables
- A special flexible bellow profile ensures a wide application range
- Fast and easy to fit – with minimal effort
- Corresponding accessories make labelling easy
- Permanent, high-quality labelling
- High contrast for optimum legibility

**General ordering data**

Version	CableLine, Conductor and cable markers, 8 - 16 mm, 6 x 11 mm, blue
Order No.	<a href="#">0253411741</a>
Type	CLI C 3-6 BL/WS - MP
GTIN (EAN)	4008 190096403
Qty.	20 pc(s).

Creation date June 9, 2022 10:52:25 AM CEST

Catalogue status 03.06.2022 / We reserve the right to make technical changes.

## CLI C 3-6 BL/WS - MP

**Weidmüller Interface GmbH & Co. KG**

Klingenbergstraße 26

D-32758 Detmold

Germany

www.weidmueller.com

## Technical data

### Dimensions and weights

Depth	17 mm	Depth (inches)	0.669 inch
Height	6 mm	Height (inches)	0.236 inch
Width	11 mm	Width (inches)	0.433 inch
Net weight	0.75 g		

### Temperatures

Operating temperature range	-30...80 °C
-----------------------------	-------------

### General data

Colour	blue	Colour of printing	white
Halogen	Yes	Insulation cross-section, max.	16
Material	PVC, soft, without Cadmium	Material colour according to resistance code	6
Number of markers per combination	1 Component part = Conductor and cable markers	Operating temperature range	-30...80 °C
Operating temperature range, max.	80 °C	Operating temperature range, min.	-30 °C
Orientation of print	horizontal	Printed characters	Symbols
Printing	-	Printing method	hot-embossing
Type of printing	Standard	UL 94 flammability rating	V-0
Version	MultiPack	Width	11 mm

### Conductor and cable markers

Conductor O.D.	8 - 16 mm	Conductor O.D., max.	16 mm
Conductor O.D., min.	8 mm	Conductor cross-section, max.	70 mm <sup>2</sup>
Conductor cross-section, min.	16 mm <sup>2</sup>	Cross-section for connected wire	16 - 70 mm <sup>2</sup>
Halogen	Yes		

### Classifications

ETIM 6.0	EC001530	ETIM 7.0	EC001530
ETIM 8.0	EC001530	ECLASS 9.0	27-40-04-01
ECLASS 9.1	27-40-04-01	ECLASS 10.0	27-40-04-01
ECLASS 11.0	27-28-11-02	ECLASS 12.0	27-28-11-02

### Approvals

ROHS	Conform
------	---------

### Downloads

Engineering Data	<a href="#">EPLAN, WSCAD</a>
Product Change Notification	<a href="#">PCN CableLine_DE</a> <a href="#">PCN CableLine_EN</a>
Catalogues	<a href="#">Catalogues in PDF-format</a>